

Profile Wapiti Deluxe Van Canada

Modèle standard

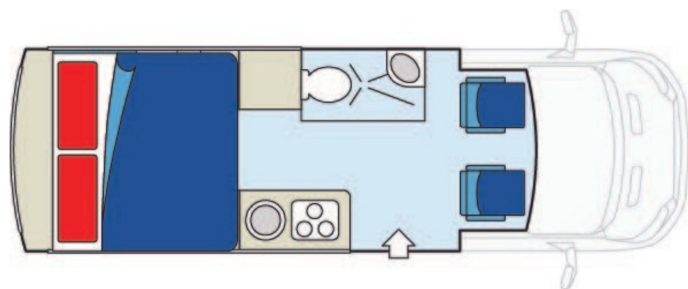
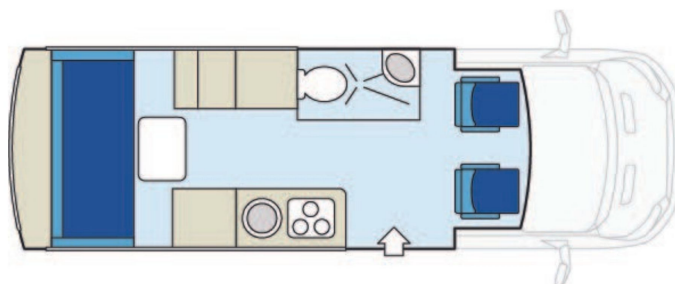

| | |
|-----------------|---|
| Description | <p>Economic and easy to drive, this comfortable 2 person campervan comes complete with shower, toilet, and kitchen.</p> <p>The plans, dimensions and layouts of the Wapiti Deluxe Van are indicative and may vary without notice.</p> |
| Characteristics | <p>Wapiti Deluxe Van Sleeps : 2 Engine gasoline 3.7 L Approximative consumption 15-20L/100km (11-15 mpg) Automatic transmission Power steering Cruise control Driver's cabin open to main cabin ? Virtual visit of the Wapiti Deluxe Van model here.</p> |
| Fuel | Gasoline |
| Dimensions | <p>Length: 6.8 m (22'2") Width: 2.1 m (7') Height: 3.1 m (9'11") Interior height: 1.9 m (6'3")</p> |
| Passengers | Sleeps 2 |

| | |
|---------------------------|--|
| Reserve | Fuel tank: 94 L (25 US gal) Fresh water tank: 102 L (27 US gal) Grey water tank: 56 L (15 US gal) Black water tank: 45 L (12 US gal) Propane tank: 37 L (9.8 US gal) |
| Beds | Double bed: 193 x 172 cm (76" x 68") |
| Kitchen | Sink (hot and cold water) Cooker 2 stoves Microwave Fridge + freezer (170L 6 cu ft.) |
| Shower/Toilet | Shower Toilet Hot and cold water |
| Heating/Air Conditionning | Heating and air conditioning in the driver's cabin Heating and air conditioning while parked |
| Energy | On-Board Generator. Allows for use of wall plugs, micro-wave, heating and air conditioning when vehicle is not connected to an electrical hook-up. Propane Gas. Allows for use of the refrigerator, water heater, and heater, while not connected to an electrical hook-up. Electrical Connection 110V (Hook-up). Auxiliary battery. Allows to operate the lights. It has an autonomy of about 12 hours and is recharged while driving, by the solar panel or being connected to 110V. AUX port/USB. Remember to take adapters to recharge small electrical appliances such as telephones or cameras. |
| Audio & Connexions | Radio TV |
| Complementary Equipment | Fire extinguisher Solar panel |