

# Profile Kingdom Small England

Modèle standard

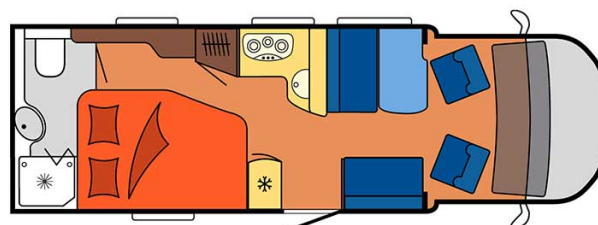
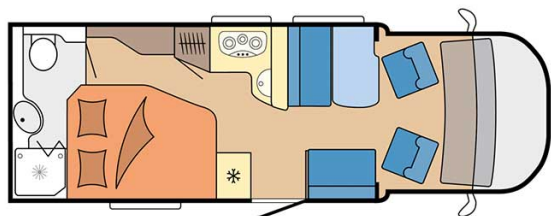
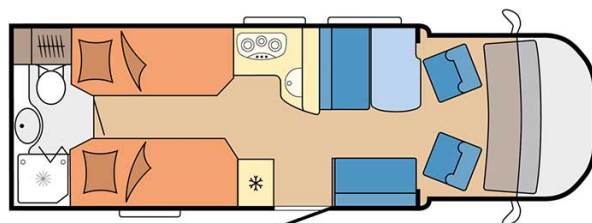
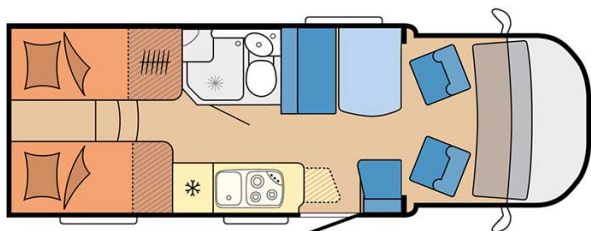
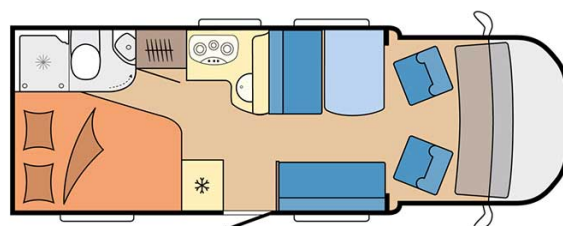

Description	<p>This motorhome is perfect for adventurous couples as it is compact and comfortable and can travel small, country roads, as well as city areas.</p> <p>The plans, dimensions and layouts here are indicative and may vary without notice.</p> <p><a href="#">VIDEO - Motorhome orientation.</a></p>
Characteristics	<p><b>Kingdom Small</b></p> <p>Sleeps : 2</p> <p>Turbo Diesel Engine</p> <p>Fiat/Citroen/Ford chassis</p> <p>Manual or automatic transmission</p> <p>Airbags</p> <p>Navigation</p> <p><a href="#">? Virtual visit of the Kingdom Small model here.</a></p>
Fuel	<p>Diesel</p> <p>Average consumption: 10-12 L/100km</p>

Dimensions	Length: 5.90 to 7.60 m Width: 2.30 to 2.40 m Height: 2.50 to 3.20 m
Passengers	2 sleeps
Reserve	Fuel tank: 90L (23.8 US gal) Fresh water tank: 100L (26.4 US gal) Waste water tank: 96L (25.4 US gal)
Beds	Double rear bed: 190-200 x 90-140 cm (75"-79" x 35"-55")
Kitchen	Sink (hot and cold water) Cooker 3 stoves Fridge min. 80L Dishes and cutlery
Shower/Toilet	Shower Toilet Hot and cold water
Heating/Air Conditionning	Heating and air conditioning like in a car Heating while parked
Energy	<b>Gas.</b> Allows for use of the refrigerator, water heater, and heater, while not connected to an electrical hook-up. <b>Electrical Connection 230V (Hook-up)</b> <b>Auxiliary Battery.</b> Batteries will last around 12 hours depending on use, and are recharged when driving the vehicle, or hooked up the 230V connection. <b>USB 12V outlet:</b> Remember to bring your adaptors for charging your personal electronics such as cameras and phones.
Audio & Connexions	Radio AM/FM Bluetooth
Complementary Equipment	First aid kit Leveling blocks Fly screens Sun curtains Fire extinguisher Tyre repair kit Cleaning set Storage compartment: 80 x 40 cm Awning
Optional Equipment	updated 05/09/25