

Profile Bothy Voyager Scotland

Modèle standard

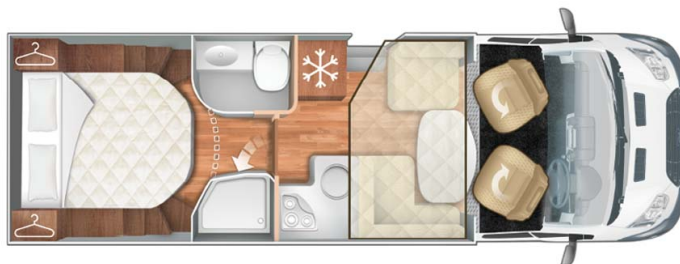

| | |
|-----------------|--|
| Description | The Bothy Voyager has a great layout and sleeps 4 people. The sliding door at the rear of the motorhome creates an en-suite bedroom with an island bed and bed side tables. Perfect for a family of 4 who would like to have some intimacy. |
| Characteristics | Bothy Voyager 4 Berth Sleeps : 4 (4 seatblets) Chassis Ford Diesel 2.0 TDI engine (Adblue required) Automatic 6 gear transmission Cruise control Backup camera ABS Airbags Internal walk-through access Central locking RHD Exterior locker storage |
| Fuel | Diesel (Adblue required) Average consumption: 10-11 L/100km (25-28 miles per gallon) |

| | |
|---------------------------|---|
| Dimensions | Length: 7.50 m (24'7") Width: 2.35 m (7'9") Height: 3.00 m (9'11") |
| Passengers | 4 sleeps and 4 seatbelts |
| Beds | Rear double bed: 190 x 150 (75" x 59") Electric drop down double bed: 212 x 103 cm (83" x 41") |
| Kitchen | Sink (hot and cold water) Cooker Oven Fridge Dishes and cutlery Kettle and toaster |
| Shower/Toilet | Shower Toilet Hot and cold water |
| Heating/Air Conditionning | Heating and air conditioning like in a car When parked the heating functions using gas or an external power outlet/hook up of 240V |
| Energy | Propane Gas. Allows the use of the refrigerator, hob, water heater, and heater, while not connected to an electrical hook-up. Electrical Connection 110V (Hook-up). Needed to fully power the motorhome. Allows the use of the socket and fridge. A generator can also be used in place of a 240V mains hook up. Auxiliary Battery. Allows for use of lights, water pump, TV and USB charging points while the vehicle is not hooked up to the 240V connection. Batteries will last around 12 hours depending on use, and are recharged when driving the vehicle, hooked up the 110V connection or by the photovoltaic panels. 12V outlet: Remember to bring your adaptors for charging your personal electronics such as cameras and phones. 120W photovoltaic panels |
| Audio & Connexions | Radio AM/FM TV and DVD player Roof mounted TV aerial |
| Complementary Equipment | Anchor points for baby/child/booster seats Backup camera Roof mounted TV aerial Photovoltaic panels UK campsite guides and Atlas Dishes and cutlery Kettle and toaster Internal walk-through access Central locking Window blinds and flyscreens Exterior locker storage: - height: 77 cm - width: 140 cm - length: 216 cm |
| Optional Equipment | Baby/child/booster seats Bike rack (up to 4 bikes) Sheets, duvets and pillows Towels Camping table and chairs Sat Nav Snow chains Toilet chemicals BBQ European mains hook up adaptor Clothes rack Adblue |