

Motorhome Bothy Mystery 6 Berth Scotland

Modèle standard



Bothy
Rambler 6 Berth



Bothy
Pioneer 6 Berth



Bothy
Adventurer 6 Berth

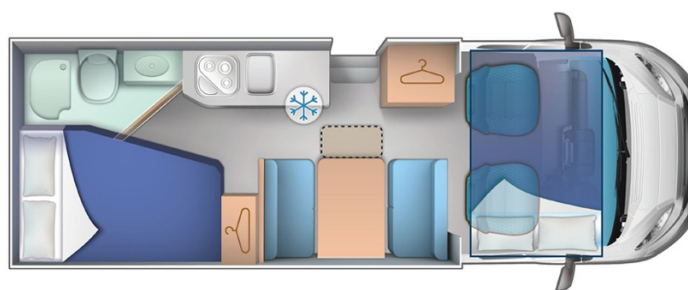

Bothy Rambler 6 Berth

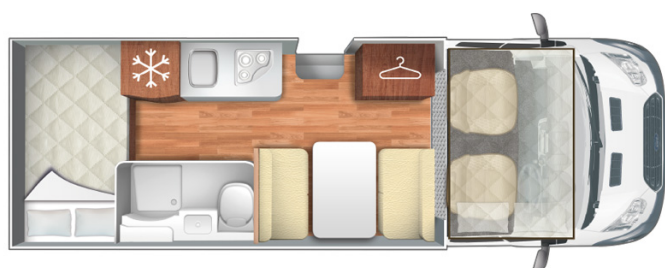

Bothy Pioneer 6 Berth

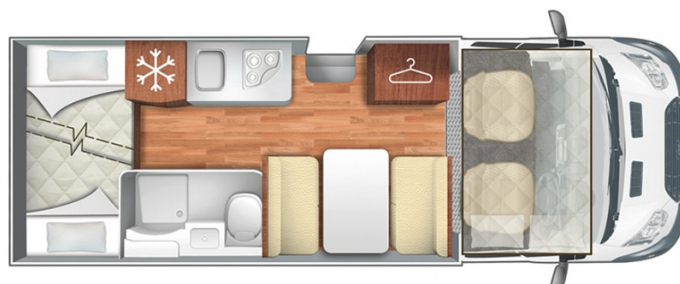

Bothy Adventurer 6 Berth

Description

Hire an up to date, high quality, fully kitted out motorhome and save money. Choose the Bothy Mystery 6 Berth motorhome; we guarantee you will get a vehicle that sleeps your chosen berth but you could have any of the Bothy 6 Berth motorhome (Rambler, Pioneer or Adventurer). Bunk beds, separate bedroom, U-shaped lounge; it's a mystery until your start your holiday.

Characteristics	<p>Bothy Rambler 6 Berth Sleeps : 6 (6 seatblets) Chassis Fiat Diesel 2.3 MultiJet engine (Adblue required) Automatic 6 gear transmission Cruise control Backup camera ABS Airbags Internal walk-through access Central locking RHD Exterior locker storage</p> <p>Bothy Pioneer 6 Berth Sleeps : 6 (6 seatblets) Chassis Fjord Diesel 2.0 TDI (Adblue required) Automatic 6 gear transmission Cruise control Backup camera ABS Airbags Internal walk-through access Central locking RHD Exterior locker storage</p> <p>Bothy Adventurer 6 Berth Sleeps : 6 (6 seatblets) Chassis Fjord Diesel 2.0 TDI (Adblue required) Automatic 6 gear transmission Cruise control Backup camera ABS Airbags Internal walk-through access Central locking RHD Exterior locker storage</p>
Fuel	Diesel (Adblue required) Average consumption: 10-11 L/100km (25-28 miles per gallon)
Dimensions	Length: 7.00 m (23') Width: 2.35 m (7'9") Height: 3.20 m (10'6")
Passengers	6 sleeps and 6 seatbelts
Beds	<p>Bothy Rambler 6 Berth Cabover bed: 200 x 165 cm (79" x 65") Dinette bed: 192 x 134 cm (76" x 53") Rear bed: 195 x 124 cm (77" x 49")</p> <p>Bothy Pioneer 6 Berth Cabover bed: 209 x 160 cm (82" x 63") Dinette bed: 186 x 130 cm (73" x 51") Rear bed: 215 x 128 cm (85" x 50")</p> <p>Bothy Adventurer 6 Berth Cabover bed: 209 x 160 cm (82" x 63") Dinette bed: 186 x 130 cm (73" x 51") Rear bed: 215 x 128 cm (85" x 50") each</p>
Kitchen	Sink (hot and cold water) Cooker Oven Fridge Dishes and cutlery Kettle and toaster

Shower/Toilet	Shower Toilet Hot and cold water
Heating/Air Conditionning	Heating and air conditioning like in a car When parked the heating functions using gas or an external power outlet/hook up of 240V
Energy	<p>Propane Gas. Allows the use of the refrigerator, hob, water heater, and heater, while not connected to an electrical hook-up.</p> <p>Electrical Connection 110V (Hook-up). Needed to fully power the motorhome. Allows the use of the socket and fridge. A generator can also be used in place of a 240V mains hook up.</p> <p>Auxiliary Battery. Allows for use of lights, water pump, TV and USB charging points while the vehicle is not hooked up to the 240V connection. Batteries will last around 12 hours depending on use, and are recharged when driving the vehicle, hooked up the 110V connection or by the photovoltaic panels.</p> <p>12V outlet: Remember to bring your adaptors for charging your personal electronics such as cameras and phones.</p> <p>120W photovoltaic panels</p>
Audio & Connexions	Radio AM/FM TV and DVD player Roof mounted TV aerial
Complementary Equipment	Anchor points for baby/child/booster seats Backup camera Roof mounted TV aerial Photovoltaic panels UK campsite guides and Atlas Dishes and cutlery Kettle and toaster Internal walk-through access Central locking Window blinds and flyscreens Exterior locker storage
Optional Equipment	Baby/child/booster seats Bike rack (up to 4 bikes) Sheets, duvets and pillows Towels Camping table and chairs Sat Nav Snow chains Toilet chemicals BBQ European mains hook up adaptor Clothes rack Adblue