

Profile Kings B 20-22 United States

Modèle deluxe

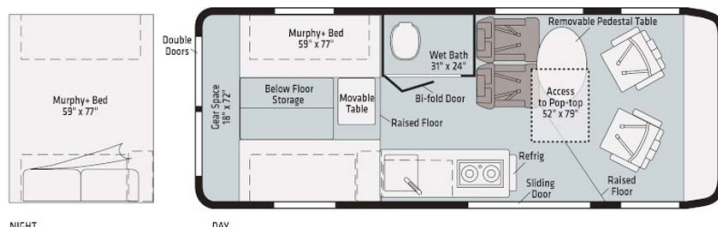

Ultrafabrics
UF2 Premium
Leatherette

Vinyl

2022 SOLIS 59PX



Description	This vehicle max. 1 year old is ideal for couples or families of 2 adults and 2 children , the Kings B20-22 allows the family to travel in comfort and tranquillity with its high quality equipment and interior and high fuel efficiency .
Characteristics	Kings B 20-22 Sleeps : up to 4 Max. 1 year old model Engine V6 Automatic transmission Cruise control Backup camera ? Virtual visit of the Kings B20-22, 2023-2024 model here.
Fuel	Average consumption: 17L/100km (14 mileaeg/mpg)
Dimensions	Length: 6.4 m (21') Width (without mirrors): 2.06 m (6'9") Height: 2.87 m (9'5") Interior height: 1.9 m (6'3")
Passengers	Sleeps 4 and 4 seatbelts - Forward facing seats and front swivel seats.

Reserve	Fuel tank: 91 L (24 US gal) Fresh water tank: 76 L (20 US gal) Grey water tank: 76 L (20 US gal)
Beds	Rear folding bed: 196 x 150 cm (77" x 59") Roof topbed: 200 x 132 cm (79" x 52")
Kitchen	Fridge with freezer Cooker 2 stoves
Shower/Toilet	Shower Toilet Sink Hot and cold water
Heating/Air Conditionning	Drivers Cabin A/C Main cabin A/C Heating
Energy	On-Board Generator. Allows for use of wall plugs, heating and air conditioning when vehicle is not connected to an electrical hook-up. Propane Gas. Allows for use of the refrigerator, water heater, and heater, while not connected to an electrical hook-up. Electrical Connection 110V (Hook-up) Auxiliary Battery. Allows for use of lights. Batteries will last around 12 hours depending on use, and are recharged when driving the vehicle, or hooked up the 110V connection. When booking a campsite, choose 30 amp (or 20 amp) connections. Wall Sockets: Only function when the vehicle is connected to 110V connection or while running the on-board generator. 12V outlet: Remember to bring your adaptors for charging your personal electronics such as cameras and phones.
Audio & Connexions	Radio AM/FM USB connectivity
Complementary Equipment	Child seat tether anchor Hitch
Optional Equipment	Bike carrier