

Profile Drakkar Small Norway

Modèle deluxe

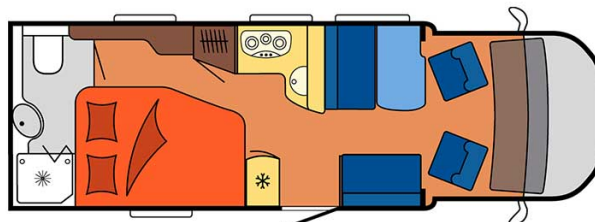
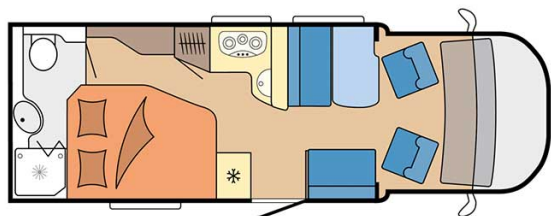
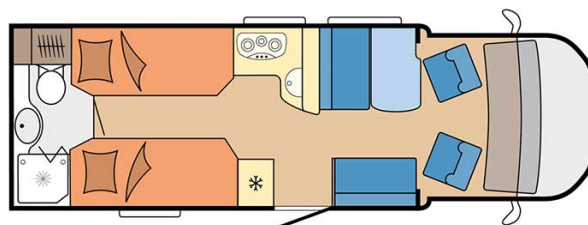
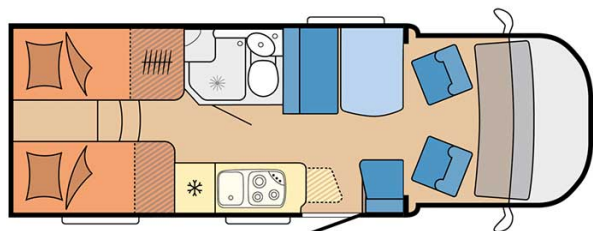
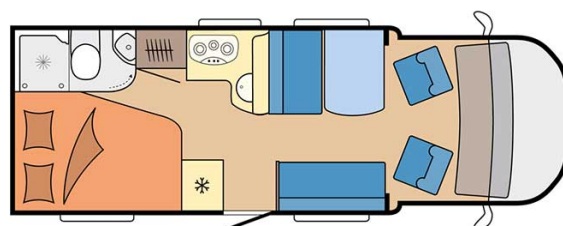

| | |
|-----------------|--|
| Description | <p>updated 12/2023</p> <p>This motorhome is perfect for adventurous couples as it is compact and comfortable and can travel small, country roads, as well as city areas.</p> <p>The plans, dimensions and layouts here are indicative and may vary without notice.</p> <p>VIDEO - Motorhome orientation.</p> |
| Characteristics | <p>Drakkar Small</p> <p>Sleeps : 2</p> <p>Turbo Diesel Engine</p> <p>Fiat/Citroen/Ford chassis</p> <p>Manual or automatic transmission</p> <p>Airbags</p> <p>Navigation</p> <p>? Virtual visit of the Drakkar Small model here.</p> |
| Fuel | <p>Diesel</p> <p>Average consumption: 10-12 L/100km</p> |

| | |
|---------------------------|--|
| Dimensions | Length: 5.90 to 7.60 m Width: 2.30 to 2.40 m Height: 2.50 to 3.20 m |
| Passengers | 2 sleeps |
| Reserve | Fuel tank: 90L (23.8 US gal) Fresh water tank: 100L (26.4 US gal) Waste water tank: 96L (25.4 US gal) |
| Beds | Double rear bed: 190-200 x 110-140 cm (75"-79" x 43"-55") or two single beds: 2 x 90 x 200 cm |
| Kitchen | Sink (hot and cold water) Cooker 3 stoves Fridge min. 80L Dishes and cutlery |
| Shower/Toilet | Shower Toilet Hot and cold water |
| Heating/Air Conditionning | Heating and air conditioning like in a car Heating while parked |
| Energy | Gas. Allows for use of the refrigerator, water heater, and heater, while not connected to an electrical hook-up. Electrical Connection 230V (Hook-up) Auxiliary Battery. Batteries will last around 12 hours depending on use, and are recharged when driving the vehicle, or hooked up the 230V connection. 12V outlet: Remember to bring your adaptors for charging your personal electronics such as cameras and phones. |
| Audio & Connexions | Radio AM/FM Bluetooth |
| Complementary Equipment | First aid kit Leveling blocks Fly screens Sun curtains Fire extinguisher Tyre repair kit Cleaning set Storage compartment: 80 x 40 cm Awning |