

Motorhome Mesa Wanderer United States

Modèle standard

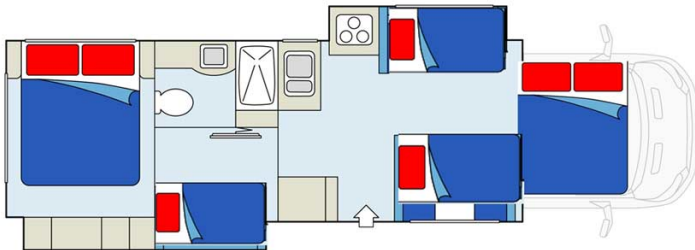
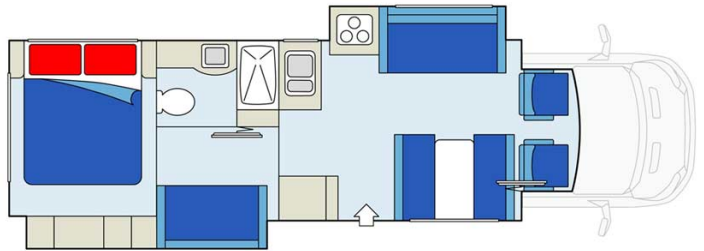
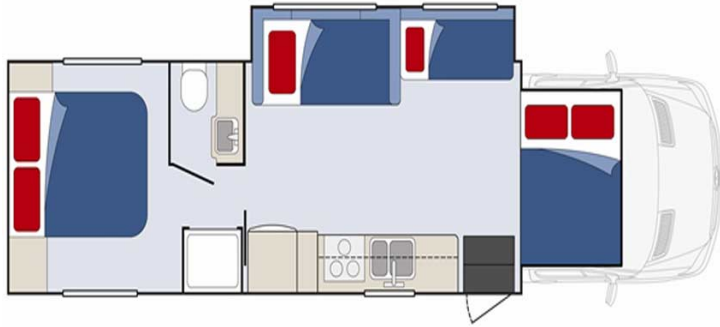
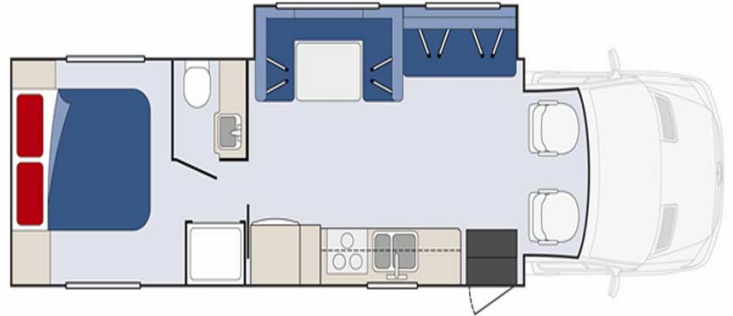

Description	This motorhome guaranteed maximum 2 years old is perfectly adapted to families of up to 7 people, offering great comfort thanks to its appliances and layout. But caution, children less than 2 years old cannot travel in this vehicle.
Characteristics	Mesa Wanderer Slide out Sleeps : 7 (4 adults and 3 children) Please note: Children less than 2 years old cannot travel in this vehicle. Model guaranteed maximum 2 years old Engine gasoline 6.8 L Automatic transmission Power steering Slide-out (extension) Driver's cabin open to main cabin
Fuel	Gasoline Average consumption : 20-25 L/100 km (10-12 mileage/mpg)

Dimensions	Length: 9.1 to 10 m (29'10" to 32'10") (from April 1st 2020: 9.7 m to 10 m (30' to 33')) Width: 2.6 m (8'6") Height: 3.4 m (11'3") (from April 1st 2020: 3.3 m (11')) Interior height: 2.1 m (6'10")
Passengers	7 (4 adults and 3 children maximum)
Reserve	Fuel tank: 208 L (55 US gal) Fresh water tank: 166 L (44 US gal) Grey water tank: 132 L (35 US gal) (from April 1st 2020: 147 L (39 US gal)) Black water tank: 113 L (30 US gal) (from April 1st 2020: 113 L (30 US gal)) Propane : 37 L (9.8 US gal)
Beds	Queen bed : 200 cm x 150 cm (79" x 59") Cabover bed : 240 cm x 140 cm (94" x 55") Dinette bed : 180 cm x 110 cm (71" x 43") Sofa bed : 150 cm x 110 cm (59" x 43") From April 1st 2020 : Cabover bed : 200 cm x 150 cm (80" x 60") Queen bed : 180 cm x 150 cm (74" x 60") Dinette bed : 170 cm x 100 cm (68" x 42") Sofa bed : 150 cm x 100 cm (60" x 40") Note: sizes may vary by model
Kitchen	Fridge : 170 L (44.9 US gal) with freezer Microwave Cooker 3 stoves Dishes and cutlery Hot and cold water
Shower/Toilet	Shower Toilet Hot and cold water
Heating/Air Conditionning	Driver's cabin A/C Main cabin A/C Heating
Energy	On-Board Generator. Allows for use of wall plugs, micro-wave, heating and air conditioning when vehicle is not connected to an electrical hook-up. Propane Gas. Allows for use of the refrigerator, water heater, and heater, while not connected to an electrical hook-up. Electrical Connection 110V (Hook-up) Auxiliary Battery. Allows for use of lights while the vehicle is not hooked up to the 110V connection. Batteries will last around 12 hours depending on use, and are recharged when driving the vehicle, or hooked up the 110V connection. Wall Sockets: Only function when the vehicle is connected to 110V connection or while running the on-board generator. 12V outlet: Remember to bring your adaptors for charging your personal electronics such as cameras and phones.
Audio & Connexions	Radio AM/FM CD player and USB/AUX port TV, DVD player
Complementary Equipment	Slide out Rear vision camera Extinguisher Anchor points for one baby seat and one booster seat, or 2 booster seats
Optional Equipment	Baby/booster seat