

# Motorhome Lakka Large Finland

Modèle deluxe

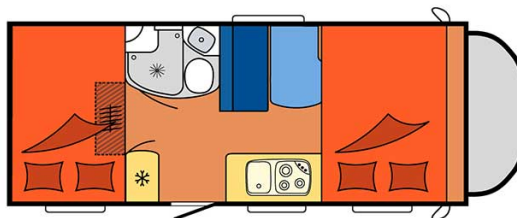
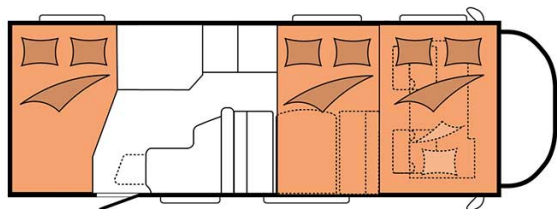
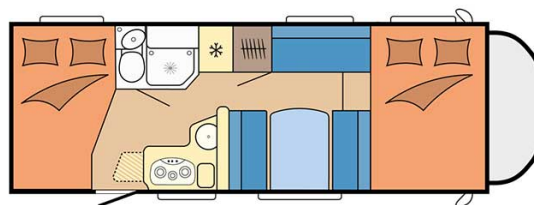
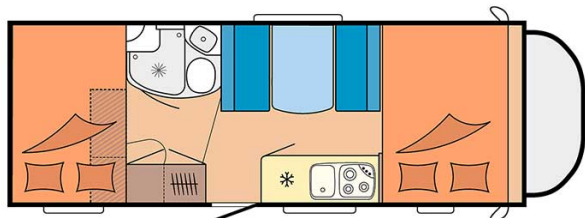
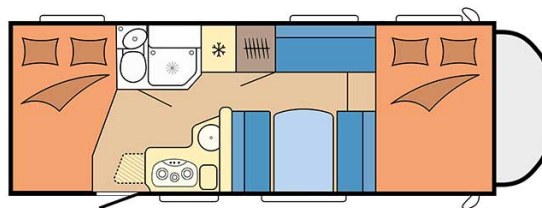

Description	<p>updated 12/2023</p> <p>This vehicle is designed to accommodate up to 5 or 6 people in great comfort. It has 3 double beds and large storage spaces.</p> <p>The plans, dimensions and layouts here are indicative and may vary without notice.</p> <p><a href="#">VIDEO - Motorhome orientation.</a></p>
Characteristics	<p><b>Lakka Large</b></p> <p>Sleeps: 5</p> <p>Turbo Diesel Engine</p> <p>Fiat/Citroen chassis</p> <p>Manual transmission</p> <p>Airbags</p> <p>Navigation</p> <p><a href="#">? Virtual visit of the Lakka Large model here.</a></p>
Fuel	<p>Diesel</p> <p>Average consumption: 10-12 L/100km</p>

Dimensions	Length: 6.30 to 7.60 m Width: 2.30 to 2.40 m Height: 3.00 to 3.20 m
Passengers	5 sleeps
Reserve	Fuel tank: 90L (23.8 US gal) Fresh water tank: 100L (26.4 US gal) Waste water tank: 96L (25.4 US gal)
Beds	Front bed: 210 cm x 150-160 cm Dinette bed: 180-210 cm x 100-130 cm Rear bed: 210-215 cm x 140 cm
Kitchen	Sink (hot and cold water) Cooker 3 stoves Fridge min. 80L Dishes and cutlery
Shower/Toilet	Shower Toilet Hot and cold water
Heating/Air Conditionning	Heating and air conditioning like in a car Heating while parked
Energy	<b>Gas.</b> Allows for use of the refrigerator, water heater, and heater, while not connected to an electrical hook-up. <b>Electrical Connection 230V (Hook-up)</b> <b>Auxiliary Battery.</b> Batteries will last around 12 hours depending on use, and are recharged when driving the vehicle, or hooked up the 230V connection. <b>12V outlet:</b> Remember to bring your adaptors for charging your personal electronics such as cameras and phones.
Audio & Connexions	Radio AM/FM Bluetooth
Complementary Equipment	Leveling blocks Fly screens Sun curtains Tire repair kit Fire extinguisher First aid kit 4 x three-point seat belts + 1 x two-point belt Electric cable Adapter Storage compartment: 66x111cm / 115x80cm / 100x80cm