

Motorhome Erable C31 Slide-Out Canada

Modèle deluxe

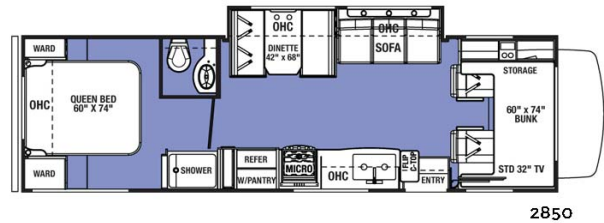
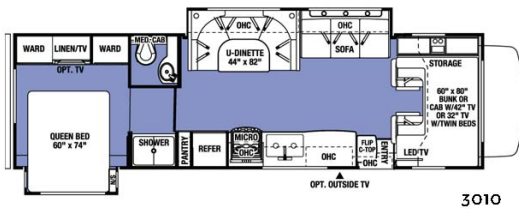
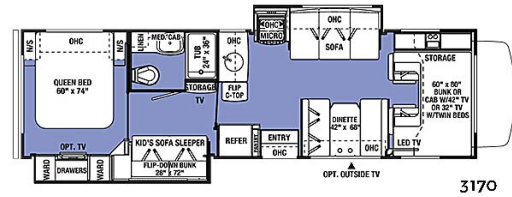

Description

This slide-out motorhome has 4 beds and many storage compartments. It offers good value for money and has everything necessary for a comfortable journey for 6 to 7.

Characteristics

Erable C31 Slide Out: Sleeps: 7; Seatbelts: 6 à 7; Model: Forest River Sunseeker 2850/3010/3170; Gasoline engine V8 or V10;Unleaded Gasoline Approx: 25-30L/100km (7-9 mpg); Ford chassis; Automatic transmission; Extension (1 or 2); Radio/CD; TV/DVD; AC and heating like in a car; AC when parked via external power outlet (hook up) 110V or a generator; Heating when parked runs on propane gas but requires an via external power outlet (hook up) 110V or a generator; Generator: Enables the functioning of the wall plugs, microwave, air conditioning and heating when the vehicle is not running or plugged in to an external power outlet (hook up). Gas (propane): Enables the functioning of the fridge, water heater and heating when the vehicle is not running or plugged in to an external power outlet (hook up). External power "hook up" 110V Auxiliary battery: Enables the functioning of the lights. This battery remains charged for 12 hours and recharges when the vehicle is driving or plugged in to an external power outlet (110 V hook up). Cigarette lighter. Charges small electrical appliances such as mobile phones and cameras with an adaptor.

Complimentary equipment: Slide-out; Awning
Motorhome accessories and preparation fees: the price includes the first bottle of propane gas, toilet chemicals, cords and pipes for hooking up to external electricity points and water drainage, a 110V adaptor for hooking up to external electricity points at camping sites.

Optional Equipment: GPS; Child Seat
Premium Kits per person (minimum 2 per vehicle): one time fee covering all bedding (pillows, pillow covers, sleeping bags, comforters, sheets, bath towels, washcloths, hand towels, hangers), dishes and cookware (plates, bowls, mugs, glasses, knives, forks, spoons, pots and pans, tea-pot, carving knife, baking sheet, mixing and salad bowls, and colander), camping chairs, broom and dustpan, clothesline, trash can, dishcloths, oven mitt or handle, bottle opener, toaster, vegetable peeler, and coffee maker.

Dimensions: from Length: 9.90 m (32'3"); Width: 2.50 m (8'4"); Height: 3.50 m (11'3"); Fuel tank: 208 L (55 US gal); Fresh water tank: 167 L (44 US gal); Grey water tank: 148 L (39 US gal); Black water tank: 148 L (39 US gal)

Beds:

2850 : Over-Cab Bed: 152 cm x 203 cm (4'11" x 6'7"); Dinette Bed: 106 cm x 172 cm (3'5" x 5'7"); Sofa Bed: 137 cm x 203 cm (4'6" x 6'7"); Rear Bed: 152 cm x 187 cm (4'11" x 6'1")

3010 : Over-Cab Bed: 152 cm x 203 cm (4'11" x 6'7"); Dinette Bed: 111 cm x 203 cm (3'7" x 6'7"); Sofa Bed: 137 cm x 203 cm (4'6" x 6'7"); Rear Bed: 152 cm x 187 cm (4'11" x 6'1")

3170 : Over-Cab Bed: 152 cm x 203 cm (4'11" x 6'7"); Dinette Bed: 106 cm x 172 cm (3'5" x 5'7"); Sofa Bed: 111 cm x 172 cm (3'7" x 5'7"); Rear Bed: 152 cm x 187 cm (4'11" x 6'1"); Bunk Bed: 76 cm x 182 cm (2'5" x 5'11")

Bathroom and Kitchen: Fridge (170 L/44.9 US gal); Microwave; 3 cooktop burners; Microwave ;Sink; Shower; Toilet; Hot and cold water