

# Motorhome Wombat Slider Australia

Modèle standard

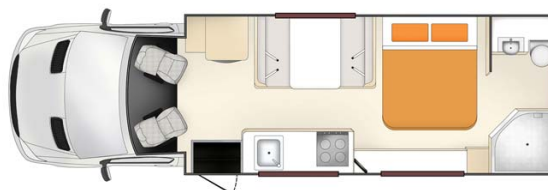

## Description

The first model in Australia to be equipped with a slide-out to offer you more space. You will love the freedom of travelling where you want with a well equipped kitchen, shower, toilet and air conditioning at your disposal. Please note that children under the age of 7 years cannot travel in this vehicle.

Several models may be proposed for the Wombat Slider, so the dimensions and arrangements may vary.

## Characteristics

### Wombat Slider

Couchages : 4 (4 seatbelts)

**Please note that children under the age of 7 years cannot travel in this vehicle.**

Engine Diesel 3.0 L

Automatic transmission

Power steering

ABS & Airbags

Slide-out

Awning

Driver's cabin open to main cabin

Rear vision camera from April 1st 2020

**Model guaranteed maximum 3 years old**



Fuel	Diesel Average consumption : 14 L/100 km
Dimensions	Length: 7.90 m (25'11") Width: 2.40 m (7'10") Height: 3.40 m (11'1") Interior height: 2.10 m (6'10")
Passengers	4 sleeps and 4 seatbelts (4 adults maximum)
Reserve	Fuel tank: 125L (33.0 US gal) Fresh water tank: 100L (26.4 US gal) Grey water tank: 150L (39.6 US gal) Gas bottle: 1 x 4.5 kg, 1 x 2 kg (from April 1st 2020: 2 x 4.5kg)
Beds	Double bed: 210 x 140 cm (82" x 55") Double bed: 190 x 150 cm (74" x 59")
Kitchen	Sink (hot and cold water) Cooker 2 stoves, 1 hotplate Fridge 175 L + freezer Microwave (240 V) Grill Oven Dishes and cutlery Gas bottle: 1 x 4.5 kg, 1 x 2 kg (from April 1st 2020: 2 x 4.5kg)
Shower/Toilet	Shower (hot and cold water) Toilet
Heating/Air Conditionning	Heating/Air conditioning driving: like in a car Heating/Air conditioning stopped: by 240V electrical connexion
Energy	<b>Gas.</b> Allows operation of the refrigerator, water heater and heater when the vehicle is not connected to the mains. 1 x 4.5 kg, 1 x 2 kg (from April 1st 2020: 2 x 4.5kg) <b>240V "hook up" connection</b> <b>Auxiliary battery.</b> Allows to operate the lights. It has an autonomy of about 12 hours and is recharged while driving or being connected to 240V. <b>Cigar lighter.</b> Remember to take adapters to recharge small electrical appliances such as telephones or cameras.
Audio & Connexions	Radio and USB port TV + DVD player
Complementary Equipment	Fire extinguisher Awning Slide-out Fly screens on some windows Rear vision camera from April 1st 2020
Optional Equipment	Camping table and chairs