

Motorhome Wapiti Promo DVC, SVC or TCA Canada

Modèle standard



Wapiti Deluxe Van



Wapiti Super Van



Wapiti Truck Pick-Up

Floor plan Deluxe Van

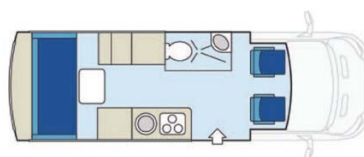
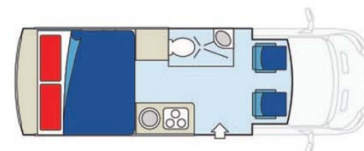

Floor Plan Super Van

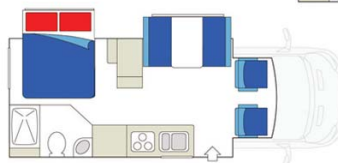
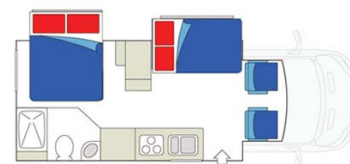

Floor plan Truck Pick-Up

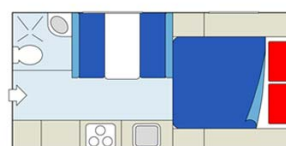
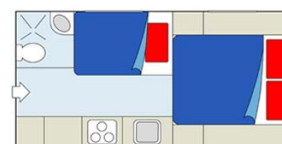

Description

Special Price - When you book a 2 person trip to Canada, one of these three vehicles will be offered to you depending on availability at up to 20% off!

Characteristics	<p>When booking with this promotion, one of the three following vehicles will be applied to your trip:</p> <p>Wapiti Deluxe Van Sleeps : 2 Engine gasoline 3.7 L Approximative consumption 15-20L/100km (11-15 mpg) Automatic transmission Power steering Control cruise Driver's cabin open to main cabin ? Virtual visit of the Wapiti Deluxe Van model here.</p> <hr/> <p>Wapiti Super Van Sleeps : 4 Engine gasoline 6.8 L Approximative consumption 25-30L/100km (8-10 mpg) Automatic transmission Power steering Cruise control Slide-out Driver's cabin open to main cabin Rearview camera (2021 models and newer) ? Virtual visit of the Wapiti Super Van model here.</p> <hr/> <p>Wapiti Truck Pick-Up Sleeps : 3 Engine diesel 6.7 L Approximative consumption 16L/100km (14 mpg) Automatic transmission Power steering Cruise control ? Virtual visit of the Wapiti Truck Pick-up model here.</p>
Fuel	<p>Wapiti Deluxe Van Gasoline</p> <hr/> <p>Wapiti Super Van Gasoline</p> <hr/> <p>Wapiti Truck Pick-Up Diesel</p>

Dimensions	<div><div>Wapiti Deluxe Van</div><div>Length: 6.8 m (22'2") Width: 2.1 m (7') Height: 3.1 m (9'11") Interior height: 1.9 m (6'3")</div></div> <div><div>Wapiti Super Van</div><div>Length: 7.0-8.2 m (23'-27') Width: 2.6 m (8'6") Height: 3.4 m (11'3") Interior height: 2.1 m (6'10")</div></div> <div><div>Wapiti Truck Pick-Up</div><div>Length: 7.00-7.60 m (23-25') Width: 2.50 m (8'2") Height: 3.60 m (12') Interior height: 1.82 m (6'4")</div></div>
Passengers	<div><div>Wapiti Deluxe Van</div><div>2 sleeps</div></div> <div><div>Wapiti Super Van</div><div>4 sleeps</div></div> <div><div>Wapiti Truck Pick-Up</div><div>3 sleeps</div></div>
Reserve	<div><div>Wapiti Deluxe Van</div><div>Fuel tank: 94 L (25 US gal) Fresh water tank: 109 L (29 US gal) Grey water tank: 56 L (15 US gal) Black water tank: 45 L (12 US gal) Propane tank: 37 L (9.8 US gal)</div></div> <div><div>Wapiti Super Van</div><div>Fuel tank: 208 L (55 US gal) Fresh water tank: 167 L (44 US gal) Grey water tank: 132 L (35 US gal) Black water tank: 132 L (35 US gal) Propane tank: 37 L (9.8 US gal)</div></div> <div><div>Wapiti Truck Pick-Up</div><div>Fuel tank: 144 L (38 US gal) Fresh water tank: 125 L (33 US gal) Grey water tank: 91 L (24 US gal) Black water tank: 49 L (13 US gal) Propane tank: 2 x 9 kg</div></div>

Beds	<p>Wapiti Deluxe Van</p> <p>Double bed: 193 x 172 cm (76" x 68")</p> <hr/> <p>Wapiti Super Van</p> <p>Rear bed: 203 x 152 cm (80" x 60") Dinette bed: 168 x 104 cm (66" x 41")</p> <hr/> <p>Wapiti Truck Pick-Up</p> <p>Cabover bed: 203 x 152 cm (80" x 60") Dinette bed: 172 x 94 cm (68" x 37") or 132 x 101 cm (40" x 30")</p>
Kitchen	<p>Wapiti Deluxe Van</p> <p>Sink (hot and cold water) Cooker 2 stoves Microwave Fridge + freezer</p> <hr/> <p>Wapiti Super Van</p> <p>Sink (hot and cold water) Cooker 3 stoves Oven or microwave (convection) Fridge + freezer</p> <hr/> <p>Wapiti Truck Pick-Up</p> <p>Sink (hot and cold water) Cooker 3 stoves Microwave Fridge + freezer</p>
Shower/Toilet	<p>Shower Toilet Hot and cold water</p>
Heating/Air Conditionning	<p>Heating and air conditioning in the driver's cabin Heating and air conditioning while parked</p>
Energy	<p>Propane Gas 110V "hook up" connection Auxiliary battery. Allows to operate the lights. It has an autonomy of about 12 hours and is recharged while driving, by the photovoltaic panels or being connected to 240V. Cigar lighter. Remember to take adapters to recharge small electrical appliances such as telephones or cameras. Photovoltaic panels</p> <p><u>Only in Wapiti Deluxe Van and Wapiti Super Van models :</u></p> <p>On-Board Generator. Allows for use of wall plugs, micro-wave, heating and air conditioning when vehicle is not connected to an electrical hook-up. (except for Wapiti Truck pick-up)</p>
Audio & Connexions	<p>Radio</p>

Complementary Equipment	Wapiti Deluxe Van Fire extinguisher Solar panel
	Wapiti Super Van Fire extinguisher Solar panel
	Wapiti Truck Pick-Up Fire extinguisher