

Luxury Mesa Traveler United States

Modèle standard

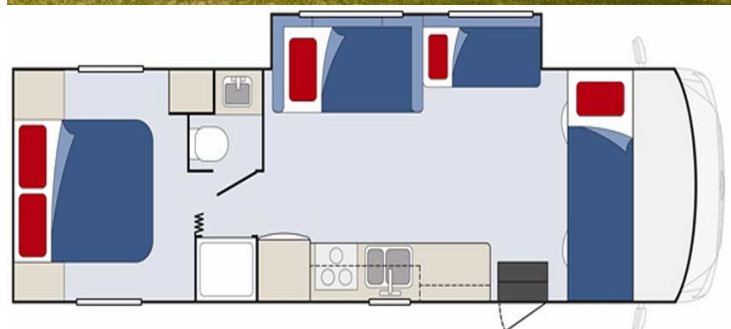
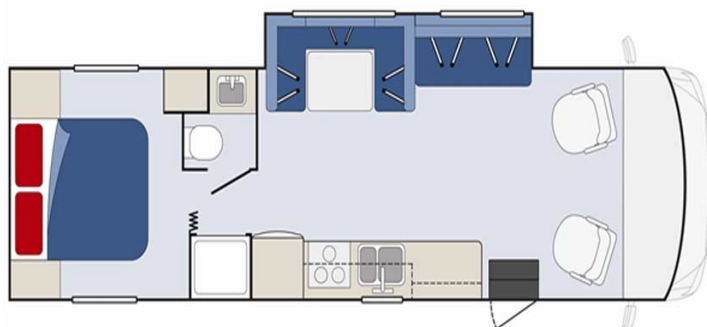

Description

This 2016 luxury model has everything you need: panoramic windshield, back-up camera, fully equipped kitchen, separate bedroom with king bed, all for comfortable travel for up to 5 passengers.

<p>Characteristics</p>	<p>Mesa Traveler-Classe A " Panoramic vision" Sleeps : 5 (adults), Please note that children under the age of 8 years cannot travel in this vehicle! Models gauranteed to have maximum of 12 months usage, 6.8 L petrol engine, Approx: 30-35L/100 km (7mpg), Ford chassis, Automatic transmission, Power steering, Driver's cabin open to living area Air conditioning and heating like in a car, Air conditioning when parked via external power outlet (hook up) 110V or a generator, Heating when parked runs on propane gas but requires an via external power outlet (hook up) 110V or a generator, Radio, TV LCD, DVD player</p> <p>Generator 295kW. Enables the functioning of the wall plugs, microwave, air conditioning and heating when the vehicle is not running or plugged in to an external power outlet (hook up).</p> <p>Gas (propane). Enables the functioning of the fridge, water heater and heating when the vehicle is not running or plugged in to an external power outlet (hook up).</p> <p>External power "hook up" 110V</p> <p>Auxiliary battery. Enables the functioning of the lights. This battery remains charged for 12 hours and recharges when the vehicle is driving or plugged in to an external power outlet (110 V hook up). When booking camp sites, choose hook ups of 20 or 30 Amps.</p> <p>Cigarette lighter. Charges small electrical appliances such as mobile phones and cameras with an adaptor.</p> <p>Complimentary equipment : Slide out, Rear vision/reversing camera, Fire extinguisher</p> <p>Optional equipment : Premium Kit per person including linen and towels, Camping chairs, Camping table, GPS, WC/toilet chemicals</p> <p>Dimensions : Length: 9.4 m (30'10"), Width: 2.6 m (8'6"), Height: 3.7 m (12'2"), Interior height: 2.0 m (6'6"), Petrol/Gas tank: 283 L (74.8 US gal), Fresh water tank: 242 L (63.9 US gal), Grey water tank: 155 L (40.9 US gal)</p> <p>Beds : Rear bedroom bed: 190 cm x 150 cm (75" x 59"), Over cab bed: 200 cm x 80 cm (79" x 32"), Dinette bed: 210 cm x 110 cm (83" x 43"), Sofa bed: 150 cm x 100 cm (59" x 39")</p> <p>Kitchen & Bathroom : Fridge: 170 L (44.9 US gal), Oven, Microwave, 3 burner stove, Dishes and kitchen ware, Hot and cold water, Shower, Toilet, Hot and cold water</p>
------------------------	--