

Profile Thor Luxury Iceland

Modèle deluxe

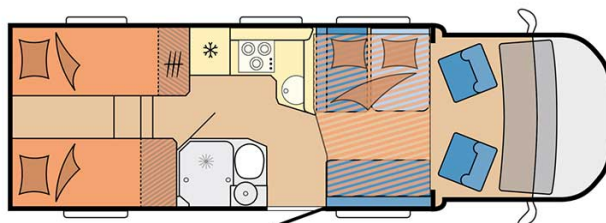
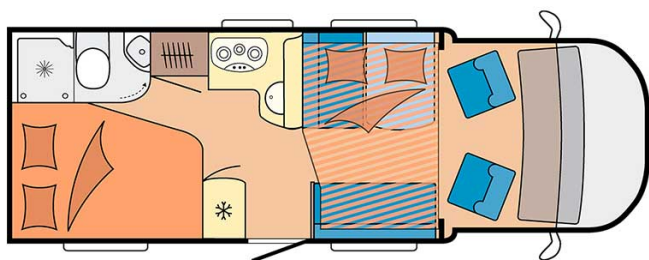
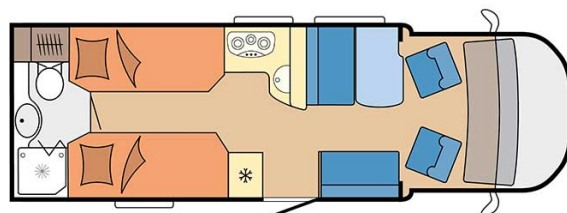

Description	<p>If comfortable is not enough, why not go for luxury? This quality vehicle can accommodate 4 people and offers great comfort.</p> <p>Layout and photos are examples. The layout of the rental vehicle may differ.</p> <p>VIDEO - Motorhome orientation.</p>
Characteristics	<p>Thor Luxury</p> <p>Sleeps : 4</p> <p>Turbo Diesel Engine</p> <p>Chassis: Fiat / Citroën / Ford / Peugeot</p> <p>Manual or automatic transmission</p> <p>Airbags</p> <p>Navigation system</p> <p>Plus a range of additional premium features (premium kitchenware, premium bedlinen set, TV, air?conditioning in living area, VIP transfer, welcome gift, camping set, final cleaning, gas bottle, toilet chemical, additional driver, Wi?Fi, etc.)</p> <p>? Virtual visit of the Thor Luxury model here.</p>

Fuel	Diesel Average consumption: 10-12 L/100km
Dimensions	Length: 5.50–6.80 m Width: 2.00–2.30 m Height: 2.50–3.00 m
Passengers	4 sleeps
Reserve	Fuel tank: 90L (23.8 US gal) Fresh water tank: 95L (25.1 US gal) Waste water tank: 90L (23.8 US gal)
Beds	Rear double bed: 185-201 x 115-157 cm
Kitchen	Sink (hot and cold water) Cooker 3 stoves Fridge 80L Dishes and cutlery
Shower/Toilet	Shower Toilet Hot and cold water
Heating/Air Conditionning	Heating and air conditioning like in a car Heating and air conditioning while parked
Energy	Gas. Allows for use of the refrigerator, water heater, and heater, while not connected to an electrical hook-up. Electrical Connection 230V (Hook-up) Auxiliary Battery. Batteries will last around 12 hours depending on use, and are recharged when driving the vehicle, or hooked up the 230V connection. USB & 12V outlet. Remember to bring your adaptors for charging your personal electronics such as cameras and phones.
Audio & Connexions	Radio AM/FM with Bluetooth Flat screen TV
Complementary Equipment	Leveling blocks Fly screens Sun curtains Tire repair kit Fire extinguisher First aid kit Ceinture de sécurité à trois points Electric cable Adapter Storage compartment: 90 x 25 / 75 x 29 (cm)
Optional Equipment	updated 05/09/25