

Luxury Erable A33 Slide-Out Canada

Modèle deluxe

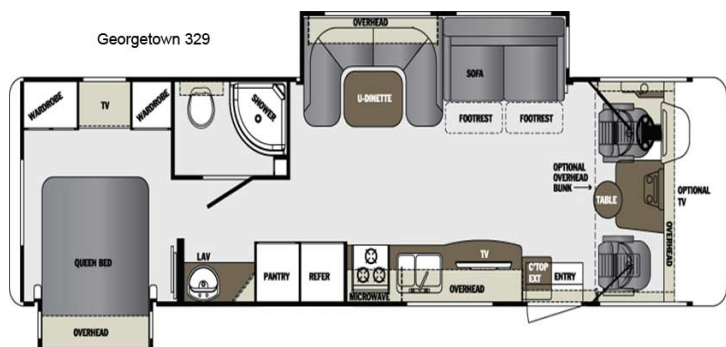

Description	Travel around Quebec in complete comfort and luxury in this top of the line model. Due to bedding configuration, we do not recommend this vehicle for groups larger than 4 people.
Characteristics	Erable A33 Slide-Out: Sleeps 5; ; Seatbelts: 5 (ideal for 4 passengers); Engine: 7.0L Isuzu; 2 slide-outs; Unleaded gasoline Approx : 25-35L/100km (7-8L/100km); Connection; AC and heating from drivers cabin while driving; AC by 110V hook-up by propane however also requires hook-up to 110V connection or on-board generator; Generator: Allows for the function of the wall plugs, micro-wave, air conditioning while parked; Propane Gas: Allows for the function of the refrigerator, water heater, a propane furnace; Hook-Up; Auxiliary Battery: Allows for the function of the interior lights. Has a 12V battery connected to 110V hook-up or while the vehicle is in motion; 12V Plug: Remember to unplug personal electronics such as cameras and phones.

Complimentary Equipment: Back-up camera; Awning; Double slide-out; Motorhome Accessories and Preparation Fees: One-time fee including initial preparation, 110V adaptor for electrical hook-ups at campsites

Optional Equipment: GPS; Child Seat; Premium Kits per person (minimum 2 persons) (pillows, pillow covers, sleeping bags, comforters, sheets, bath towels, washcloths, plates, bowls, mugs, glasses, knives, forks, spoons, pots and pans, tea-pot, coffee pot, etc.)

bowls, and colander), camping chairs, broom and dustpan, clothesline, trash can, toaster, vegetable peeler, and coffee maker.

Dimensions: Length: 10.7 M (34'11"); Width: 2.5 M (8'4"); Height: 3.7 M (12'1")
tank: 189L (50gal); Grey-water tank: 155L (41 gal); Black-water tank: 155L (41 gal)

Beds: Rear bed: 152 cm x 187 cm (4'11"x6'1"); Dinette bed: 111 cm x 208 cm (4'5"x5'7")

Bathroom and Kitchen: Refrigerator; Microwave; Stove; Sink; Shower; Toilet;

From January 1st 2019

Erable A33 Slide-Out: Sleeps 6; ; Seatbelts: 6 (ideal for 4 adults and 2 children); Georgetown ; 2 slide-outs; Unleaded gasoline Approx : 25-35L/100km (7-10mpg) and heating from drivers cabin while driving; AC by 110V hook-up or on-board generator however also requires hook-up to 110V connection or on-board generator while in motion; function of the wall plugs, micro-wave, air conditioning and heating, while the vehicle is parked; function of the refrigerator, water heater, and heating while parked; 110V Electrical function of the interior lights. Has a 12 hour autonomy and can be recharged while the vehicle is in motion; 12V Plug: Remember to bring your adaptors to charge your mobile phones.

Complimentary Equipment: Back-up camera; Awning; Double slide-out
Motorhome Accessories and Preparation Fees: One-time fee including initial preparation, cables, 110V adaptor for electrical hook-ups at campsites

Optional Equipment: GPS; Child Seat; Premium Kits per person (minimum 2 persons) (pillows, pillow covers, sleeping bags, comforters, sheets, bath towels, washcloths, plates, bowls, mugs, glasses, knives, forks, spoons, pots and pans, tea-pot, coffee pot, bowls, and colander), camping chairs, broom and dustpan, clothesline, trash can, toaster, vegetable peeler, and coffee maker.

Dimensions: Length: 10.4 M (34'6"); Width: 2.5 M (8'4"); Height: 3.6 M (12'3")
tank: 189L (50gal); Grey-water tank: 158L (42 gal); Black-water tank: 158L (42 gal)

Beds: Rear bed: 187 cm x 187 cm (74"x74"); Dinette bed: 111 cm x 208 cm (44"x74")
Bunk bed : 99 cm x 162 cm (39 x 64)

Bathroom and Kitchen: Refrigerator; Microwave; Stove; Sink; Shower; Toilet;

-