

Luxury Beaver A 30 Canada

Modèle deluxe

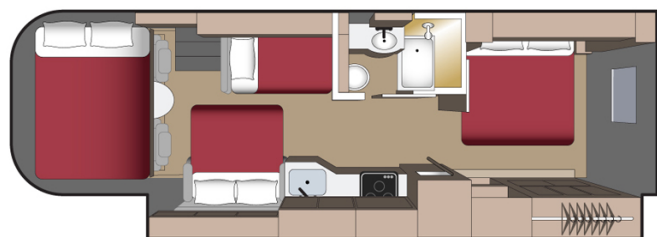
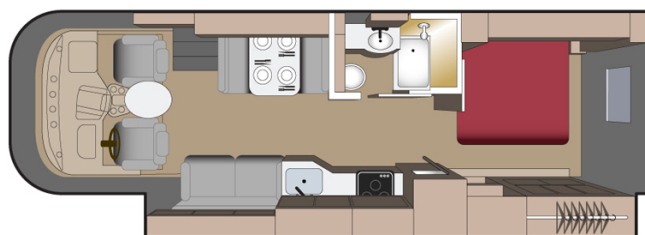

Description	<p>Explore the Canadian highways on board this spacious and comfortable motorhome.</p> <p>The plans, dimensions and layouts here of the Beaver A 30 are indicative and may vary without notice.</p>
Characteristics	<p>Beaver A 30</p> <p>Sleeps : 6</p> <p>Chassis Ford F-53</p> <p>Engine V10 gasoline</p> <p>Approximative consumption 24-37L/100km</p> <p>Automatic transmission</p> <p>Cruise control</p> <p>? Virtual visit of the Beaver A 30 model here.</p>
Fuel	Gasoline
Dimensions	<p>Length: 7.67 m (25'2")</p> <p>Width: 2.50 m (8'2") (2.66 m (9'6") with slide-out extended)</p> <p>Height: 3.40 m (11'2")</p> <p>Interior height: 2.00 m (79")</p>
Passengers	6 sleeps

Reserve	Fuel tank: 303 L Fresh water tank: 216 L Grey water tank: 155 L Black water tank: 155 L Propane: 90 L
Beds	Cabover bed: 188 x 133 cm (74" x 52") Dinette bed: 170 x 104 cm (67" x 41") Other bed: 183 x 142 cm (72" x 56") Rear bed: 196 x 185 cm (77" x 73")
Kitchen	Sink (hot and cold water) Stove Oven (propane) Microwave Fridge
Shower/Toilet	Shower Toilet Hot and cold water
Heating/Air Conditionning	Heating and air conditioning in the driver's cabin Heating and air conditioning while parked
Energy	On-Board Generator. Allows for use of wall plugs, micro-wave, heating and air conditioning when vehicle is not connected to an electrical hook-up. Propane Gas. Auxiliary Battery. Batteries will last around 12 hours depending on use, and are recharged when driving the vehicle. Battery boost. Battery that helps to quickly recharge a discharged battery. 12V outlet. Remember to bring your adaptors for charging your personal electronics such as cameras and phones. Solar panel.
Audio & Connexions	USB plug-in Bluetooth
Complementary Equipment	Awning Backup camera Tether hooks for infant, child or booster seats Solar panel