

Motorhome Antelope 6 South Africa

Modèle standard

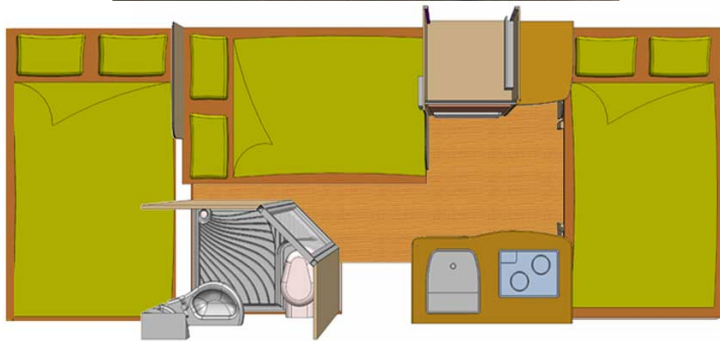
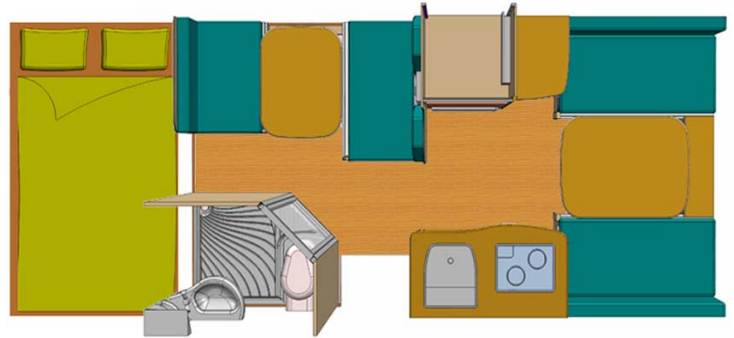

Description

updated 11/2024

Layout and fotos are examples. The layout of the rental vehicle may differ.

The Antelope 6 is a high-end family 6 berth motorhome that comfortably sleeps six adventurers, featuring air conditioning in both the driver's cabin and rear living area. It boasts a smooth 8-speed automatic gearbox, ensuring a quality travel experience.

[VIDEO 1 - Image tour of the vehicle](#)

[VIDEO 2 - Cabin layout](#)

Characteristics	<p>Antelope 6 Seatbelts: 6 Iveco 35S14 chassis Engine: 2.3L - 3L Turbo Diesel 8-speed automatic Cruise control ABS power brakes Passage from the driver's cabin to the main cabin</p> <p>? Virtual visit of the Antelope 6 model here.</p>
Fuel	<p>Diesel Approx. fuel consumption: 12L/100km</p>
Dimensions	<p>Length: 6.7 m (21'12") Height: 2.88 m (9'5") Width: 2.17 m (7'1") Interior height: 1.9 m (6'3")</p>
Passengers	6
Reserve	<p>Fuel tank: 70 L (18.5 US gal) Fresh water tank: 60 L (15.9 US gal) Gas bottle: 2 x 3 kg (6.6 lb)</p>
Beds	<p>Main bed: 125 cm x 190 cm (49" x 75") Double bed: 120 cm x 200 cm (47" x 79") Double bed: 120 cm x 200 cm (47" x 79")</p>
Kitchen	<p>Fridge/freezer (80 L/21.1 US gal) 2 stove burners Sink Microwave Hot water (220V/gas) and cold water</p>
Shower/Toilet	<p>Cassette toilet Shower</p>
Heating/Air Conditionning	<p>Air conditioning when driving: Yes Air conditioning in living area: Yes (220V) 12V living area roof ventilator</p>
Energy	<p>Gas. Allows for use of the refrigerator, water heater, and heater, while not connected to an electrical hook-up. Auxiliary Battery. Batteries will last around 12 hours depending on use, and are recharged when driving the vehicle, or hooked up the 220V connection. 12V outlet. Remember to bring your adaptors for charging your personal electronics such as cameras and phones.</p>
Audio & Connexions	<p>Radio/CD/Bluetooth depending on the model USB charging points</p>
Complementary Equipment	<p>Mosquito nets Cosy baby seat (0-6 months): max 2 Child seat (6-36 months): max 2 Booster child seat (36 months +): max 2</p>

All floorplans, measurements and specifications are approximate, not guaranteed and subject to change at any time without prior notice.